

Jonathan Hunt

ESTATE AGENCY

20 High Street Ware SG12 9BX

Tel: 01920 411090

8 High Street Buntingford SG9 9AG

Tel: 01763 272727

info@jonathan-hunt.co.uk

www.jonathanhunt.co.uk



97 Vicarage Road, Ware, SG12 7AP

£450,000

3 BEDROOM DETACHED WITH GARAGE - Requiring Refurbishment this 3 bedroom detached house with a garage to the rear. The accommodation also an offset lounge/dining room, kitchen and downstairs cloakroom with a bathroom to the first floor. Gas Central Heating. Only a 9 minute level walk to Ware High Street and 13 minute walk to Ware Station serving Liverpool Street. Located opposite Tumbling Bay Lake which is a delightful place to unwind. No onward Chain.

Buntingford Branch - Company No. 10303541 VAT No. 10303541

Ware Branch - Company No. 4759215 VAT No. 700174975

97 Vicarage Road, Ware, SG12 7AP

ENTRANCE

CLOAKROOM

LIVING ROOM 16'2" x 11'8" (4.95 x 3.56)



BEDROOM ONE 13'1" x 10'4" (4 x 3.15)



BEDROOM TWO 11'9" x 9'10" (3.6 x 3)



DINING ROOM 15'5" x 9'5" (4.7 x 2.88)



BEDROOM THREE 8'10" x 6'6" (2.7 x 2)



KITCHEN 11'11" x 6'10" (3.65 x 2.1)



FIRST FLOOR

97 Vicarage Road, Ware, SG12 7AP

BATHROOM



EXTERIOR

GARDEN



GARAGE



COUNCIL TAX BAND E



Energy Efficiency Rating		
	Current	Potential
Very energy efficient - lower running costs		
(92 plus) A		
(81-91) B		
(69-80) C		
(55-68) D		
(39-54) E		
(21-38) F		
(1-20) G		
Not energy efficient - higher running costs		
England & Wales		EU Directive 2002/91/EC

Environmental Impact (CO ₂) Rating		
	Current	Potential
Very environmentally friendly - lower CO ₂ emissions		
(92 plus) A		
(81-91) B		
(69-80) C		
(55-68) D		
(39-54) E		
(21-38) F		
(1-20) G		
Not environmentally friendly - higher CO ₂ emissions		
England & Wales		EU Directive 2002/91/EC

Ground Floor

Approx. 55.8 sq. metres (600.7 sq. feet)

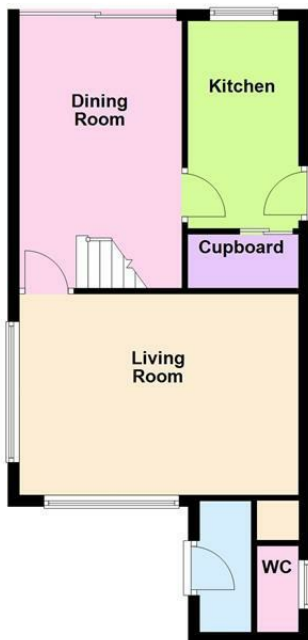
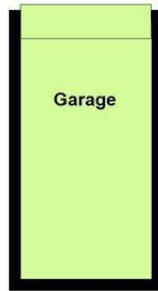

First Floor

Approx. 43.1 sq. metres (464.3 sq. feet)

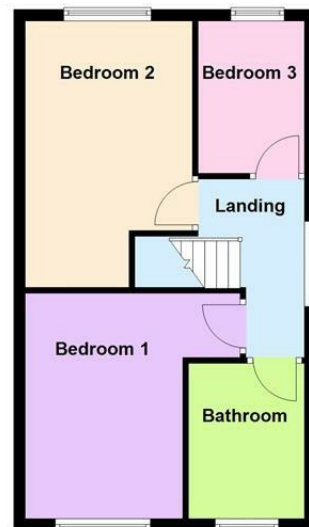

Total area: approx. 98.9 sq. metres (1064.9 sq. feet)

Whilst every attempt has been made to ensure the accuracy of the floor plan contained here, measurements of doors, windows, rooms and any other item are approximate and no responsibility is taken for any error, omission, or misstatement. This plan is for illustrative purposes only and should only be used as such by any prospective purchaser.
Plan produced using PlanUp.